

EN – Instructions for installation of house outlet with lid and child protection

decente 

Technical specification:

Type: DZ16-1DJ, DZ16-1EJ
Voltage: 250 VAC 50 / 60 Hz
Current: 16 A

Installation of switch mounting box:

- Use switch mounting box of min. depth 35 mm
- To install multiple fitting assemblies, it is necessary to use multiple boxes with 71mm spacing of centres
- The switch mounting box must be placed flat (in plane) with the plaster wall.
In case of problems with a “sunk” mounting box, the VK1 or VK2 spacer (distance) rings must be used in order to prevent deformation of the fittings when the screws are tightened.

Connecting the outlet:

- The outlets are suitable for connection of Cu wires with cross-sections of 2,5 mm²
- Strip the wires in the maximum length of 10 mm and connect. The specified tightening torque for the screws that secure the wires is 1.2 Nm.
- Fixing the outlet to the mounting box is done via the metal frame with two screws (Fig 1). The fastening screw must not have a countersunk head.
- After installation of the outlet in the box, it is necessary to verify whether the wires are fixed in the fitting terminals correctly and firmly; loose wires should be retightened.
- Place a frame (Fig. 2 – wood, glass, concrete, metal, plexi) and cover on the metal frame of the device and lock it with screws (Fig. 3).

Fig. 1

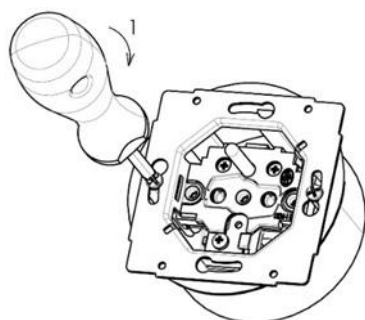

Fig. 2

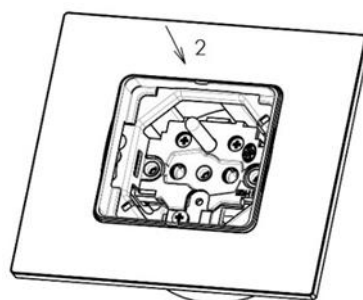
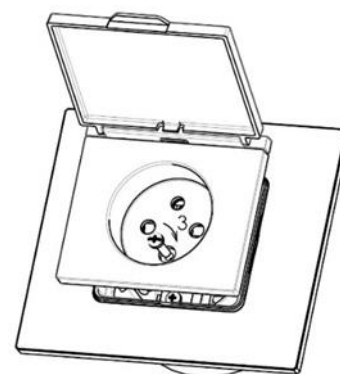
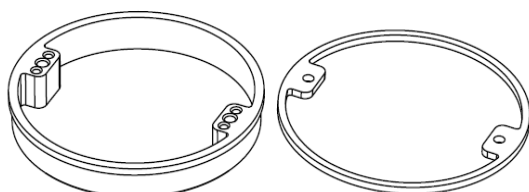

Fig. 3



VK1

VK2



Maintenance:

The outlet device does not require any maintenance!

Outlet covers must never be wiped or washed by abrasive cleaning cloths and do not use any aggressive chemicals (petrol, acetone, etc.).

Notice:

Installation and possible disassembly must be entrusted to a person with appropriate electrical qualification. Always disconnect the mains voltage before installation (dismantling)!

Do not use a broken or damaged device and secure it against use. If the device is not fitted with visible parts, it must not be energized or operated with.