

# EN – Instructions for installation of modular outlet USB with charger

## Safety during installation

The modular outlet USB with charger is intended for current up to 16 AX and voltage up to 100/240~ 50/60Hz. Output current 1.0 A nominal. Therefore, the installation must be performed by a person properly qualified in electrical engineering. Before commencing the installation, always disconnect mains voltage.

### 1. During installation of the modular outlet USB with charger, the following conditions must be observed:

- The switch mounting box must be placed flush with the plaster
- In case of problems with a “sunk” mounting box, the VK1 or VK2 spacer (distance) rings must be used in order to prevent deformation of the fittings when the screws are tightened
- The switch is fastened in the mounting box though a sheet-metal frame by means of two screws of 3 mm diameter
- To install multiple fitting assemblies, it is necessary to use multiple boxes with the spacing of centres of 71 mm
- It is recommended to place the modular outlet USB in the mounting boxes at the approximate depth of 50 mm

### 2. Connection of a modular outlet USB:

- Put the modular outlet USB into the sheet-metal frame (Fig. 1)
- Put the metal frame with modular outlet USB into the mounting box and secure it by tightening two screws (Fig. 2)
- Set the frame (Glass, Wooden, Metal, Ceramic, Concrete, Plexiglass) onto the USB outlet,
- Insert a plastic connection part and secure it by tightening the screw (Fig. 3). Take extra caution when mounting into Glass frames (full tightening can create material stress and eventually cause breaking of Glass frame)
- Insert the upper cover part (slot down – Fig. 4)
- During multiple frame installation must metal carrying frames of devices be joined continuously (without gaps)

### 3. Disassembly of switches

- Remove the upper cover part with a screwdriver: put the screwdriver into slot and pull (Fig. 5)
- After loosening the two screws, you can take out the plastic connection part and dismount the modular outlet USB

Fig. 1

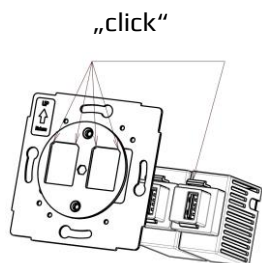

Fig. 2

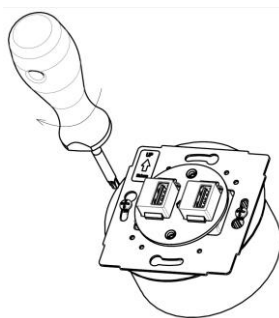

Fig. 3

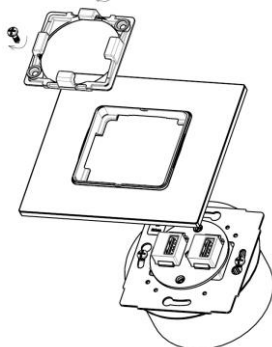

Fig. 4

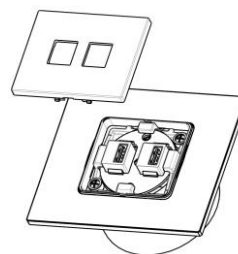
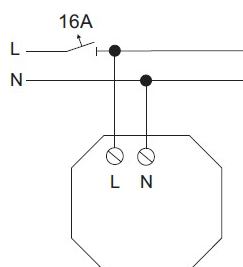
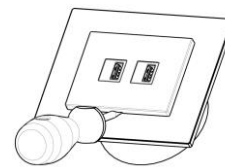

Fig. 5



Connect the wires according the wiring diagram. Put the modular outlet USB with charger into the mounting box (the approximate depth of 50 mm)

The spacer (distance) rings VK1 and VK2 aren't attached (please order them as individual item).

VK1

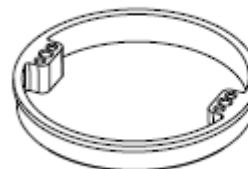

VK2



## Maintenance:

The modular outlet device does not require any maintenance!

Device covers must never be wiped or washed by abrasive cleaning cloths or aggressive chemicals (petrol, acetone, etc.) may be used on them.

The product contains no hazardous substances; after expiration of its service life, it must be handled in conformity with the waste act in force or pertinent related regulations.

Manufacturer: **OBZOR, Production Cooperative Zlín**  
Na Slanici 378, 763 02 Zlín, Czech Republic  
[www.obzorzlin.com](http://www.obzorzlin.com), [marketing@obzor.cz](mailto:marketing@obzor.cz)